

Connecting the AC Adapter (Optional)

As an alternative to battery operation, the unit features a DC adapter jack which requires a 6 volt/500mA AC adapter (not included). Have an adult connect the adapter to the unit.

- Plug the AC adapter cable into the DC adapter jack on the side of the unit and connect the plug end into a working outlet that is not controlled by a wall switch.

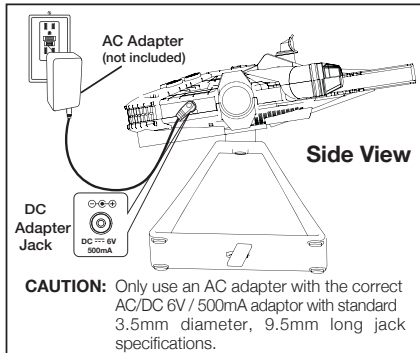

Display Brightness Using AC Power

Use the **Up** or **Down Button** to adjust the display light level from Hi, Med, Low. The display light default level is Med.

FCC Information

This device complies with Part 15 of the FCC Rules. Operation is subject to the following two conditions: (1) This device may not cause harmful interference, and (2) this device must accept any interference received, including interference that may cause undesired operation.

NOTE: This equipment has been tested and found to comply with the limits for a Class B digital device, pursuant to Part 15 of the FCC rules. These limits are designed to provide reasonable protection against harmful interference in a residential installation. This equipment generates, uses, and can radiate radio frequency energy and, if not installed and used in accordance with the instructions, may cause harmful interference to radio communications. However, there is no guarantee that interference will not occur in a particular installation. If this equipment does cause harmful interference to radio or television reception, which can be determined by turning the equipment off and on, the user is encouraged to try to correct the interference by one or more of the following measures:

- Reorient or relocate the receiving antenna.
- Increase the separation between the equipment and receiver.
- Connect the equipment into an outlet on a circuit different from that to which the receiver is connected.
- Consult the dealer or an experienced radio/TV technician for help.

FCC Information (Continued)

WARNING: Changes or modifications to this unit not expressly approved by the party responsible for compliance could void the user's authority to operate the equipment. CAN ICES-3 (B)/NMB-3(B)

Maintenance

- Protect your furniture when placing the clock on natural wood or a lacquered wood finish. A cloth or other protective material should be placed between the unit and the furniture.
- Clean the casing with a soft cloth moistened only with mild soap and water. Stronger cleaning agents may damage the surface of the case.
- If the clock is not to be used for a prolonged period, remove the batteries to prevent possible corrosion. Should the battery compartment become corroded or dirty, clean it thoroughly and replace the batteries.

Limited One Year Warranty

eKids, LLC warrants this product to be free from defects in workmanship and materials, under normal use and conditions, for a period of one year from the date of original purchase. Should this product fail to function in a satisfactory manner, it is best to first return it to the store where it was originally purchased. Should this fail to resolve the matter and service still be required by reason of any defect or malfunction during the warranty period, eKids will repair or, at its discretion, replace this product without charge. This decision is subject to verification of the defect or malfunction upon delivery of this product to the Factory Service Center authorized by Customer Service. If service is required, please call Customer Service at 1-888-TOP-TOYS to obtain a Return Authorization Number and shipping instructions.

Disclaimer of Warranty

NOTE: This warranty is valid only if the product is used for the purpose for which it was designed. It does not cover (i) products which have been damaged by negligence or willful actions, misuse or accident, or which have been modified or repaired by unauthorized persons; (ii) cracked or broken cabinets, or units damaged by excessive heat; (iii) damage to digital media players, CD's or tape cassettes (if applicable); (iv) the cost of shipping this product to the Factory Service Center and its return to the owner.

This warranty is valid only in the United States of America and does not extend to owners of the product other than to the original purchaser. In no event will eKids or any of its affiliates, contractors, resellers, their officers, directors, shareholders, members or agents be liable to you or any third party for any consequential or incidental damages, any lost profits, actual, exemplary or punitive damages. (Some states do not allow limitations on implied warranties or exclusion of consequential damages, so these restrictions may not apply to you.) This warranty gives you specific legal rights, and you may also have other rights which vary from state to state.

Your acknowledgement and agreement to fully and completely abide by the above mentioned disclaimer of warranty is contractually binding to you upon your transfer of currency (money order, cashier's check, or credit card) for purchase of your eKids product.

Questions? Visit www.ekids.com

For any other questions: 1-888-TOP-TOYS Toll Free
© & ™ Lucasfilm Ltd. Used Under License. eKids, LLC

STAR WARS™

Model SW-347E7

MILLENNIUM FALCON™ NIGHT GLOW ALARM CLOCK

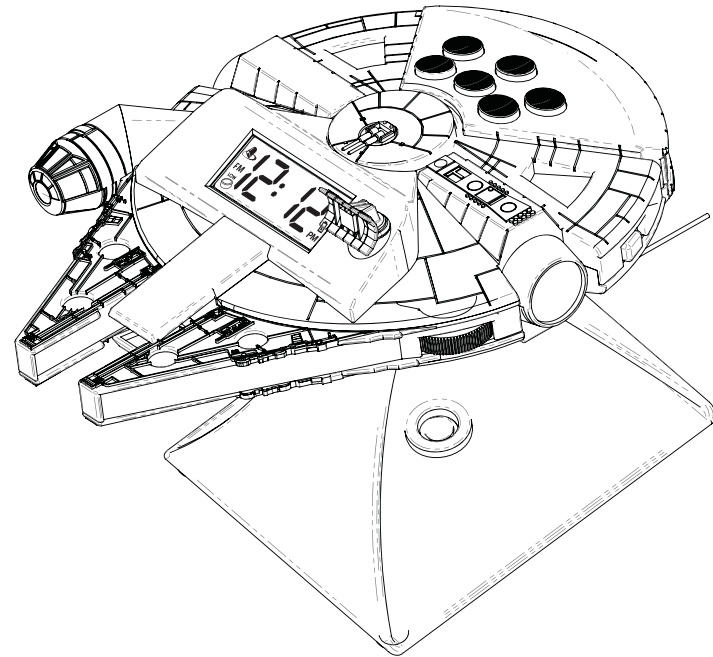

Important Message to Consumers

Thank you for purchasing one of our STAR WARS™ top-quality electronic products. Please take a moment to read through these instructions to help you understand the safe and proper way to use this product to extend its usability. Keep these instructions for future reference as they contain important information.

when the low battery icon  appears on the display.

- Using a Phillips screwdriver, open the battery compartment door located on the bottom of the unit.
- Insert 3 new AA (LR6) batteries in the battery compartment. Make sure batteries match the + and - as indicated in the battery compartment diagram.
- Replace battery compartment door. Do not overtighten screw.

Installing/Replacing the Backup Battery

This unit also comes with a CR2032 button cell battery to be used as a backup. Remove the battery pull tab before using the unit. This backup battery will save your time settings if the AA batteries become weak.

- Using a Phillips screwdriver, open the backup battery compartment door located on the bottom of the unit.
- Pinch the backup battery release tab and pull the backup battery holder free.
- Insert a CR2032 button cell battery as per diagram shown.
- Replace the backup battery holder into the unit, then replace the battery compartment door. Do not overtighten screw.

Note: Radio, Night light and SFX Buttons will not function if only back up battery is installed. Replace the CR2032 battery when you see the Low Battery indicator  flashing in the display.

WARNING : DO NOT THROW BATTERIES AWAY WITH HOUSEHOLD TRASH. PLEASE CONSULT LOCAL REGULATIONS FOR PROPER BATTERY DISPOSAL.

For the Best Possible Performance

- Only use the recommended/supplied batteries or equivalent.
- Use alkaline batteries for longer life.
- Do not mix old and new batteries, and do not mix alkaline, carbon-zinc or rechargeable nickel-cadmium batteries.
- Insert batteries with proper polarity (+/-) as indicated.
- Remove exhausted batteries from product.
- Recharge rechargeable batteries under adult supervision.
- Do not attempt to recharge non-rechargeable batteries.
- Do not open batteries or heat them beyond normal ambient temperatures.
- To prevent battery leakage or damage remove batteries from a product if it will not be used for a month or longer.
- Use extreme caution handling leaking batteries (avoid direct contact with eyes and skin). If battery leakage comes in contact with eyes, IMMEDIATELY flush the eye with lukewarm and gently flowing water for at least 30 minutes. If skin contact occurs, wash skin with clear water for at least 15 minutes. Seek medical attention if any symptoms occur.
- Store in cool, dry, ventilated area away from hazardous or combustible material.
- Do not dispose of batteries in the household trash or fire.
- Follow applicable laws and local regulations for the disposal and transportation of batteries.

Setting The Time

- Press and hold the **Time Set Button** until the display flashes.
- Press the **Up** or **Down Button** to adjust the clock to the current time (hold to set more rapidly). Make sure to set the correct AM or PM time. The PM indicator appears on the lower right corner of the time display; there is no AM indicator.
- Press the **Time Set Button** to confirm time setting.

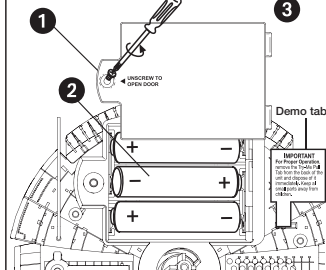

Make sure to remove this tab from the bottom of the unit. To do so, gently pull on tab. Dispose of tab properly.

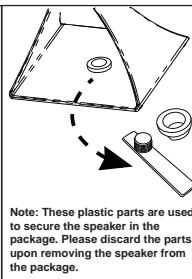
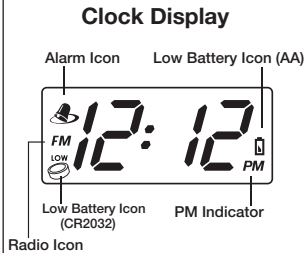
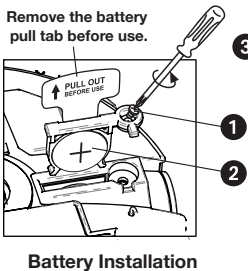
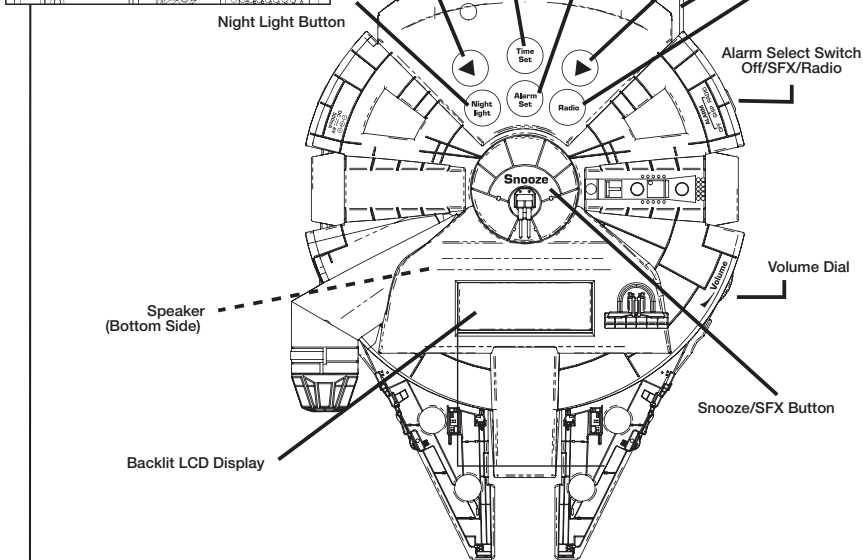

Note: These plastic parts are used to secure the speaker in the package. Please discard the parts upon removing the speaker from the package.

alarm volume.

Setting the Alarm

- Press and hold the **Alarm Set Button** until the display flashes.
- Press the **Up** or **Down Button** to adjust the display to the desired alarm time (hold to set more rapidly). Make sure to set the correct AM or PM time. The PM indicator appears to the lower right of the time display; there is no AM indicator.
- Set the **Alarm Select Switch** to "Radio" to wake to radio, set to "SFX" to wake to sound effects, or set to "Off" to disable the alarm. Alarm is active when the  icon appears on the display.
- Press the **Alarm Set Button** to confirm alarm setting.

Snooze and Alarm Reset

Press down on the **Snooze** when the alarm sounds to snooze the alarm for 7 minutes.

Press the **Alarm Set Button** to stop a sounding alarm and reset it to come on the next day at the same time.

Setting up the Radio

Untie the FM antenna and extend to its full length for best reception. DO NOT STRIP, ALTER OR ATTACH TO OTHER ANTENNAS.

Using the FM Radio

- Press the **Radio Button** to turn on the radio. Keep repeatedly pressing the Radio Button to cycle through 60, 45, 30, and 15 minute and OFF radio timer settings" which will appear on the display. When the radio is in use, the **FM** icon appears on the display
- While the radio is in use, press the **Up** or **Down Button** to adjust the frequency. Holding those buttons down will scan through frequencies more rapidly.
- Turn off the radio by pressing the **Radio Button** again. The last radio frequency setting will be remembered.

*Note: When an AC adapter is connected, an additional 'ON' setting allows the radio to stay on without timing out.

Night Light Button

Press the **Night Light Button** to activate the Night Light timer. The light will automatically shut off after 5 minutes.

Questions or Comments

For questions or comments regarding this or other eKids products, please call our toll-free number: 1-888-TOP-TOYS.

Please also visit our web site: www.ekids.com.