

Maintenance

- Place the unit on a level surface away from sources of direct sunlight or excessive heat.
- Protect your furniture when placing your unit on a natural wood and lacquered finish. A cloth or other protective material should be placed between it and the furniture.
- Clean your unit with a soft cloth moistened only with mild soap and water. Stronger cleaning agents such as thinner or similar materials can damage the surface of the unit.

A Consumer Guide to Product Safety

IMPORTANT SAFETY INSTRUCTIONS

When used in the directed manner, this unit has been designed and manufactured to ensure your personal safety. However, improper use can result in potential electrical shock or fire hazards. Please read all safety and operating instructions carefully before installation and use, and keep these instructions handy for future reference. Take special note of all warnings listed in these instructions and on the unit.

- Water and Moisture** – The unit should not be used near water. For example: near a bathtub, washbowl, kitchen sink, laundry tub, swimming pool or in a wet basement.
- Ventilation** – The unit should be situated so that its location or position does not interfere with its proper ventilation. For example, it should not be situated on a bed, sofa, rug or similar surface that may block ventilation openings. Also, it should not be placed in a built-in installation, such as a bookcase or cabinet, which may impede the flow of air through the ventilation openings.
- Heat** – The unit should be situated away from heat sources such as radiators, heat registers, stoves or other appliances (including amplifiers) that produce heat.
- Power Sources** – The unit should be connected to a power supply only of the type described in the operating instructions or as marked on the appliance.
- Power-Cable Protection** – Power supply cables should be routed so that they are not likely to be walked on or pinched by items placed upon or against them. It is always best to have a clear area from where the cable exits the unit to where it is plugged into an AC socket.
- Cleaning** – The unit should be cleaned only as recommended. See the Maintenance section of this manual for cleaning instructions.
- Objects and Liquid Entry** – Care should be taken so that objects do not fall and liquids are not spilled into any openings or vents located on the product.
- Attachments** – Do not use attachments not recommended by the product manufacturer.
- Lightning and Power Surge Protection** – Unplug the unit from the wall socket and disconnect the antenna or cable system during a lightning storm or when it is left unattended and unused for long periods of time. This will prevent damage to the product due to lightning and power-line surges.
- Overloading** – Do not overload wall sockets, extension cords, or integral convenience receptacles as this can result in a risk of fire or electric shock.
- Damage Requiring Service** – The unit should be serviced by qualified service personnel when:
 - the power supply cable or plug has been damaged.
 - objects have fallen into or liquid has been spilled into the enclosure.
 - the unit has been exposed to rain.
 - the unit has been dropped or the enclosure damaged.
 - the unit exhibits a marked change in performance or does not operate normally.
- Periods of Nonuse** – If the unit is to be left unused for an extended period of time, such as a month or longer, the power cable should be unplugged from the unit to prevent damage or corrosion.
- Servicing** – The user should not attempt to service the unit beyond those methods described in the user's operating instructions. Service methods not covered in the operating instructions should be referred to qualified service personnel.

Questions? Visit www.ekids.com

Internal Rechargeable Lithium-ion Battery

This device uses an internal rechargeable lithium-ion battery that should last the lifetime of the device. If you suspect your battery may be dead, try charging it several times. If the battery does not recharge, please contact us for repair information.

WARNING/DISPOSAL OF UNIT

Please do NOT attempt to change the battery yourself. If the battery has died and you do not want us to replace your battery, you should follow the disposal instructions below:

- Never dispose of used batteries/electronics with ordinary solid wastes, since they contain toxic substances.
- Always dispose of used batteries/electronics in accordance with the prevailing community regulations that apply to the disposal of batteries/electronics. If there are no local regulations concerning battery/electronics disposal, please dispose of the device in a waste bin for electronic devices.
- Many electronics retailers now recycle batteries and other electronic components at no charge. Check to see which ones in your area do so.

CAUTION

The battery used in this device may present a risk of fire, explosion or chemical burn if mistreated

- Never use or charge the battery if it appears to be leaking, discolored, deformed, or in any way abnormal.
- Never disassemble the unit or attempt to remove battery as that could cause leakage of alkaline solution or other electrolytic substance.
- Always confirm that the temperature is 5°C 35° C (41° - 95° Fahrenheit) before you charge the battery.
- Leakage or deterioration of the battery may occur if this warning is not heeded.
- Never expose the battery to any liquid.
- Never expose the battery to excessive heat such as direct sunlight or fire. Never use the battery pack in an unventilated vehicle where excessive internal temperatures may be encountered.
- Always keep the battery out of the reach of infants and small children.

Questions? Visit www.ekids.com
© & ™ Lucasfilm Ltd. Used Under License. eKids, LLC

Charging the Li-B56E7

The Li-B56E7 is powered by a rechargeable battery in the speaker. **Make sure to charge speaker before use, using supplied combination cable.**

- Connect the micro-USB plug to the Audio/Charging jack on the speaker.
- Connect the standard USB plug to a powered USB port, such as that on a computer. Your computer should be connected to a wall outlet when speaker is charging. The light on the speaker will turn to solid red while charging and turn off when fully charged.
- When the battery is low, the red LED light will turn on. If you start to notice sound distortion at higher volumes, it's time to recharge the batteries.

NOTE: The charging LED light will override the pairing LED light pattern.

Using Bluetooth with the Li-B56E7

- Whenever the unit is set to Bluetooth (📶) mode, the Li-B56E7 will attempt to autolink a previously paired device for 3 minutes. If no device is paired, or to pair a new device, follow the steps below:
- Make sure your Bluetooth device and the Li-B56E7 are fully charged. Turn on your Bluetooth device and turn on Bluetooth mode (check in Options or Settings).
- Slide the /OFF/AUX Switch on the speaker to the Bluetooth position (📶). Press and hold the Bluetooth Pairing Button for 3 seconds. The red LED light will flash quickly, and a tone will sound as the speaker enters pairing mode.
- "StarWarsLi-B56" should appear on your device. If "Not Connected" or similar message appears, select "StarWarsLi-B56" to connect. If your device asks for a passcode, enter "1234".
- Once paired, a confirmation tone will sound and the red LED will shut off. You can then stream audio to the speaker.
- Control Bluetooth audio from your device. Remember to turn off the speaker and your device after listening.
- If no device is paired within 3 minutes, a failure tone will sound, the red light will flash slowly and the unit will revert to standby mode. To retry pairing, press and hold the Bluetooth Pairing Button for 3 seconds. If pairing is not successful, turn the power "OFF" on the speaker and repeat pairing procedure.

NOTE: To cancel current pairing mode, quickly press the **Bluetooth Pairing Button** for 1 second.

Answer / End Calls

The Li-B56E7 also comes equipped with a Speakerphone function which will be active when a call is coming through to your linked Bluetooth device. When an incoming call is received on your device, briefly press the **Bluetooth Pairing/Speakerphone/Sound Effects** Button on the speaker once to answer the call. Press and hold for 2 seconds to reject the call. Speak into the microphone during the call. To end the call, briefly press the **Bluetooth Pairing/Speakerphone/Sound Effects** Button again.

Using the Li-B56E7 with Aux Devices

- Connect the micro-USB plug to the Audio/Charging jack on the speaker.
- Connect the stereo 3.5mm audio plug to the headphone jack or line-out of any audio device.
- Slide the /OFF/AUX Switch on the speaker to the "AUX" position.
- Press play on your audio device and adjust its volume to listen to audio.
- When done listening, move the /OFF/AUX Switch to the OFF position to turn the unit off. Remember to turn off your audio device, too.

STAR WARS

iHome

Model/Modelo/Modèle: Li-B56E7

SPECIAL FORCES TIE FIGHTER™ SPEAKER
ALTAVOZ SPECIAL FORCES TIE FIGHTER™
HAUT-PARLEUR TIE FIGHTER™ FORCES SPÉCIALES

EN ES FR

CHARGE
BEFORE USE
CARGAR
ANTES DE USAR
A CHARGER AVANT
TOUTE UTILISATION

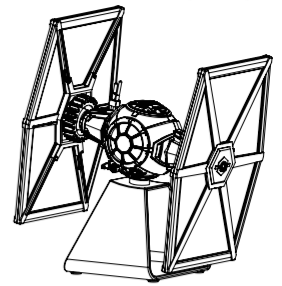

Questions? Visit www.ekids.com
¿PREGUNTAS? Visite www.ekids.com
Des questions ? Visitez www.ekids.com

BC

This item is NOT a toy



This product bears the selective sorting symbol for waste electrical and electronic equipment (WEEE). This means that this product must be handled pursuant to European Directive 2012/19/EU in order to be recycled or dismantled to minimize its impact on the environment. For further information, please contact your local or regional authorities. Electronic products not included in the selective sorting process are potentially dangerous for the environment and human health due to the presence of hazardous substances.

This device complies with the essential requirements of the R&TTE Directive 1999/5/EC. The following test methods have been applied in order to prove presumption of conformity with the essential requirements of the R&TTE Directive 1999/5/EC

IMPORTANT

Read before proceeding
If you have any question regarding the operation or use of this product, please visit www.ekids.com to view answers to frequently asked questions.
To learn more about this and other iHome products, please visit us online at www.ekids.com

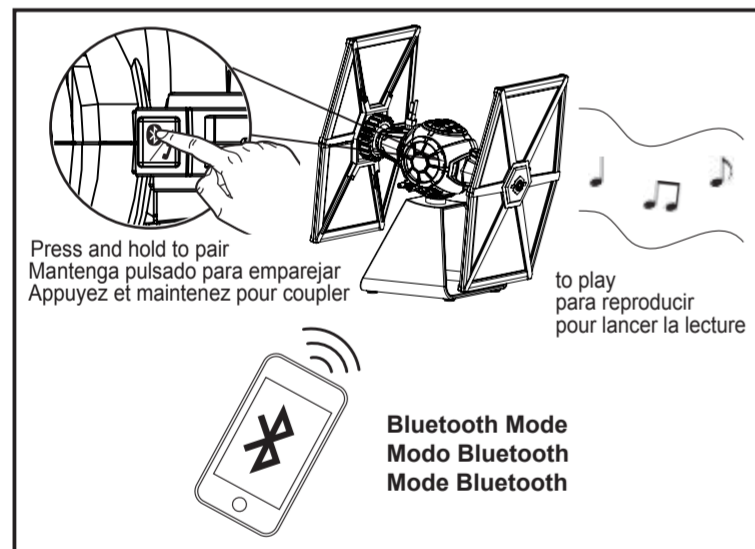

Top View Vista superior Vue de dessus

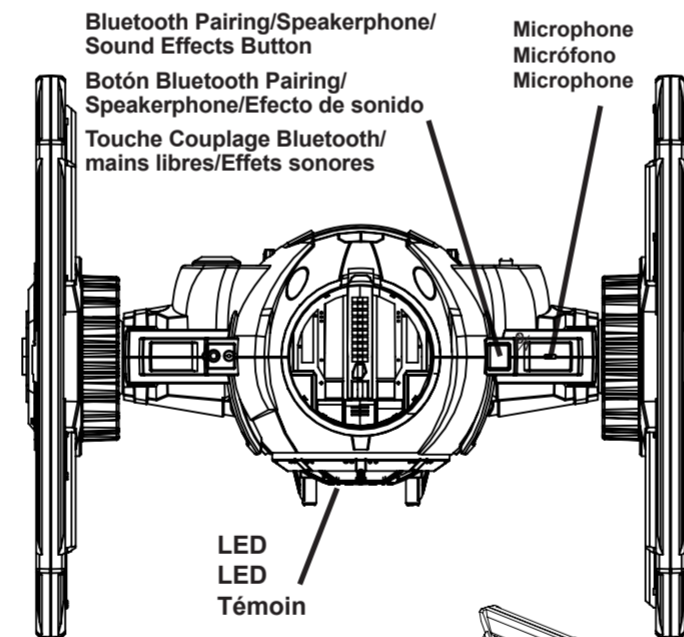

Back View Vista posterior Vue arrière

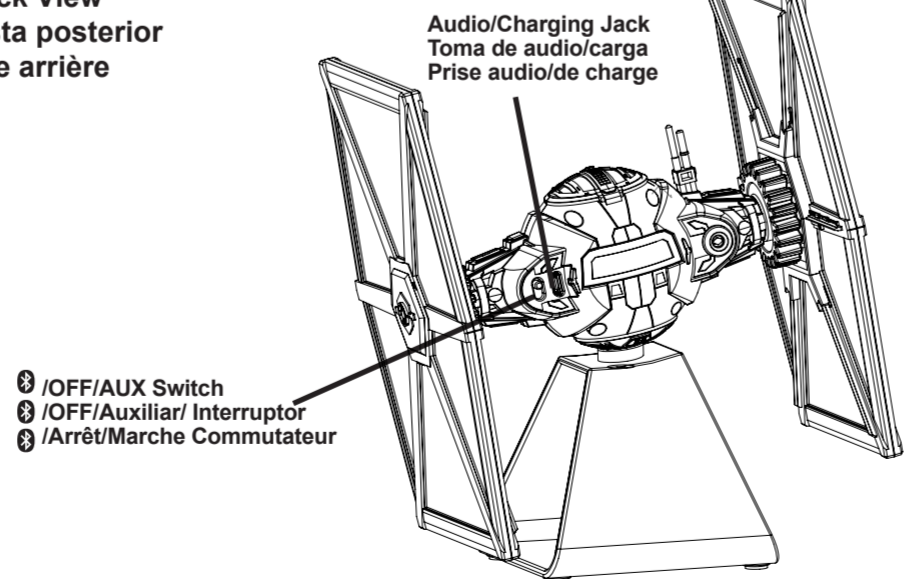

Note: The unit is equipped with a Try Me feature. Before using the unit, pull out the plastic Demo Tab located on the bottom panel and discard.
Note: The unit is equipped with a Try Me feature. When unit is OFF, press the **Bluetooth Pairing/Speakerphone/Sound Effects** Button to play/stop built-in music.
Nota: La unidad está equipada con la propiedad Pruébame. Antes de usar la unidad, extraiga y deseche la pestaña de Demostración situada en el panel inferior.
Nota: La unidad está equipada con la propiedad Pruébame. Cuando la unidad está APAGADA, pulse el botón Emparejamiento **Bluetooth Pairing/Speakerphone/Sound Effects** para reproducir / detener la música integrada.
Remarque : L'appareil est doté d'une fonction « Essaie-moi ». Avant d'utiliser l'appareil, retirez la languette de démonstration en plastique située sur le panneau inférieur.
Remarque : L'appareil est doté d'une fonction « Essaie-moi ». Lorsque l'unité est éteinte, appuyez sur la touche **Bluetooth Pairing/Speakerphone/Sound Effects** pour écouter/arrêter la musique intégrée.

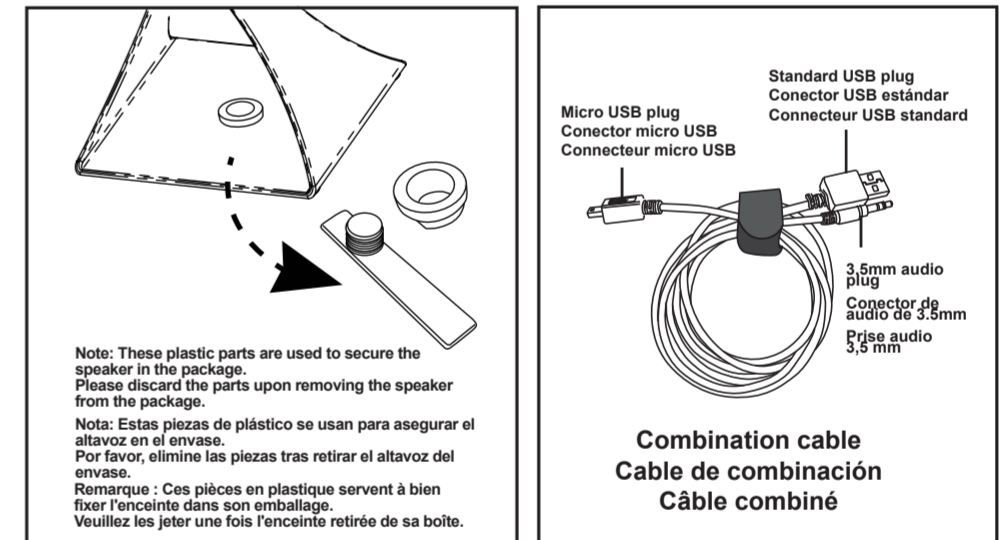

Charging the Li-B56E7 CHARGE BEFORE USE Carga del Li-B56E7 CARGAR ANTES DE USAR Chargez Li-B56E7 AVANT DE L'UTILISER

