

CHARGE BEFORE USE  
CARGAR ANTES DE USAR  
A CHARGER avant utilisation

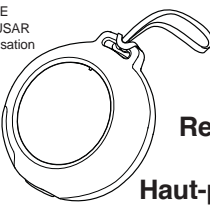

Modelo/Modelo/Modèle  
AV-B55/FD-B55/FR-B55/PW-B55



## Rechargeable Speaker Altavoz Recargable Haut-parleur rechargeable



### Important Message to Consumers

Thank you for purchasing one of our many top-quality electronic products. Please take a moment to read through these instructions to help you understand the safe and proper way to use this product to extend its usability. Keep these instructions for future reference as they contain important information.

### FCC & IC Information

#### FCC Radiation Exposure Statement

This equipment complies with FCC RF radiation exposure limits set forth for an uncontrolled environment. This device complies with Industry Canada's licence-exempt RSSs. Operation is subject to the following two conditions:  
(1) This device may not cause interference, and  
(2) This device must accept any interference, including interference that may cause undesired operation of the device. The device meets the exemption from the routine evaluation limits in section 2.5 of RSS 102 and compliance with RSS-102 RF exposure, users can obtain Canadian information on RF exposure and compliance.

This device complies with Part 15 of the FCC Rules, operation is subject to the following two conditions: (1) This device may not cause harmful interference, and (2) this device must accept any interference received, including interference that may cause undesired operation.

- Warning: Changes or modifications to this unit not expressly approved by the party responsible for compliance could void the user's authority to operate the equipment.
- NOTE: This equipment has been tested and found to comply with the limits for a Class B digital device, pursuant to Part 15 of the FCC Rules.

These limits are designed to provide reasonable protection against harmful interference in a residential installation. This equipment generates, uses and can radiate radio frequency energy and, if not installed and used in accordance with the instructions, may cause harmful interference to radio communications. However, there is no guarantee that interference will not occur in a particular installation. If this equipment does cause harmful interference to radio or television reception, which can be determined by turning the equipment off and on, the user is encouraged to try to correct the interference by one or more of the following measures:

- Reorient or relocate the receiving antenna.
- Increase the separation between the equipment and receiver.
- Connect the equipment into an outlet on a circuit different from that to which the receiver is connected.
- Consult the dealer or an experienced radio/TV technician for help.

CAN ICES-3 (B)/NMB-3(B)

This transmitter must not be co-located or operating in conjunction with any other antenna or transmitter. This equipment should be installed and operated with a minimum distance of 20 centimeters between the radiator and your body.

## Using Your Speaker

### Turning the Speaker ON/OFF

Press and hold the **Power Button** for approximately 2 seconds to turn the speaker ON or OFF. When the speaker is ON, press and release the button to play or pause the audio.

### USB Charging Port

To charge the speaker, connect the included micro USB cable to the **Charging Port** on the side of the speaker. (See "Charging the B55" for detailed charging instructions.)

### Reset Button

Quickly press the **Reset Button** to reset the speaker. To reset Bluetooth settings, press and hold the **Bluetooth Pairing Button** for 10 seconds until you hear a confirmation tone.

### Bluetooth Pairing Button

See below for detailed Bluetooth pairing instructions.

### Carry Strap

To attach the included carry strap, loop it through the hook on the top of the unit.

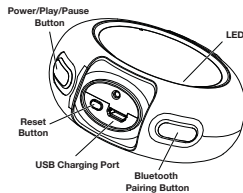

## Using Bluetooth with the B55

- Make sure your Bluetooth device and the B55 speaker are fully charged. Turn on your Bluetooth device and make it "discoverable" by turning on Bluetooth mode (check in Options or Settings).
- When the B55 speaker is ON, press and hold the **Bluetooth Pairing Button** until you hear a confirmation tone. The LED will flash blue as the speaker attempts to pair with a Bluetooth device.
- "eKids B55" should appear on your device. If "Not Connected" or similar message appears, select "eKids B55" to connect.
- Once paired, the blue LED will glow solid. You can then stream audio to the speaker, and control the music from your Bluetooth device. Remember to turn off the speaker and your device after listening.

Note: If no device is paired within 5 minutes, the speaker will automatically shut off. To retry pairing, repeat steps 1-4 above.

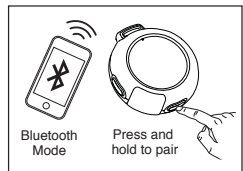

## Charging the B55

To charge the speaker, connect the included micro USB cable to the **Charging Port** on the side of the speaker. Connect the standard USB plug to a computer, USB AC adapter (not included) or other USB power source. The red LED will light up while the speaker charges, and will automatically shut off when charging is complete.

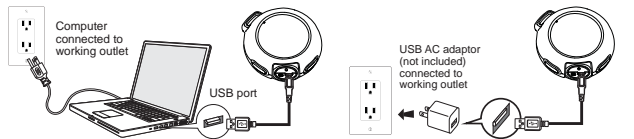

## Questions or Comments

For questions or comments regarding this or other eKids products, please call our toll-free number: 1-888-TOP-TOYS. Please also visit our website: [www.ekids.com](http://www.ekids.com)

## Limited 90 Day Warranty

eKids warrants this product to be free from defects in workmanship and materials, under normal use and conditions, for a period of 90 days from the date of original purchase. Should this product fail to function in a satisfactory manner, it is best to first return it to the store where it was originally purchased. Should this fail to resolve the matter and service still be required by reason of any defect or malfunction during the warranty period, eKids will repair or, at its discretion, replace this product without charge. This decision is subject to verification of the defect or malfunction upon delivery of this product to the Factory Service Center authorized by Customer Service. If service is required, please call Customer Service at 1-888-TOP-TOYS (1-888-967-8697) to obtain a Return Authorization Number and shipping instructions. A copy of the sales receipt is required to validate in-warranty coverage.

### Disclaimer of Warranty

NOTE: This warranty is valid only if the product is used for the purpose for which it was designed. It does not cover (i) products which have been damaged by negligence or willful acts, misuse or accident, or which have been modified or repaired by unauthorized persons; (ii) cracked or broken cabinets, or units damaged by excessive heat; (iii) damage to digital media players, CDs or tape cassettes (if applicable); (iv) the cost of shipping this product to the Factory Service Center and its return to the owner.

This warranty is valid only in the United States of America and does not extend to owners of the product other than to the original purchaser. In no event will eKids or any of its affiliates, contractors, resellers, their officers, directors, shareholders, members or agents be liable to you or any third party for any consequential or incidental damages, any lost profits, actual, exemplary or punitive damages. (Some states do not allow limitations on implied warranties or exclusion of consequential damages, so these restrictions may not apply to you.) This warranty gives you specific legal rights, and you may also have other rights which vary from state to state.

Your acknowledgment and agreement to fully and completely abide by the above mentioned disclaimer of warranty is contractually binding to you upon your transfer of currency (money order, cashier's check, or credit card) for purchase of your eKids product.

Distributed by eKids, LLC

For questions or comments please call our toll-free number: 1-888-TOP-TOYS

Also visit our website: [www.ekids.com](http://www.ekids.com)  
1239 Main Street Rahway, NJ 07065

Printed in China



## Mensaje importante para los clientes

Gracias por comprar uno de nuestros productos electrónicos de calidad superior. Por favor, tómese un momento para leer estas instrucciones que le ayudarán a entender la manera segura y apropiada de usar este juguete para extender su duración. Conserve estas instrucciones para consultas futuras, puesto que contienen información importante.

### Información de la FCC

#### Declaración de Exposición a Radiación de la FCC

This equipment complies with FCC RF radiation exposure limits set forth for an uncontrolled environment.

Este dispositivo cumple con la normativa RSS de exento de licencia de Industria de Canadá. El funcionamiento está sujeto a las siguientes dos condiciones:

- (1) este dispositivo no debe causar interferencias, y
- (2) este dispositivo debe aceptar cualquier interferencia, incluyendo interferencias que pudieran causar una operación no deseada en el dispositivo.

Este dispositivo cumple con la extensión de los límites de evaluación rutinarios de la sección 2.5 de RSS 102 y cumple con la exposición RSS-102 RF. Los usuarios pueden obtener información canadiense sobre exposición RF y cumplimiento.

Este dispositivo cumple con la Parte 15 de las normas FCC, y su funcionamiento está sujeto a las dos siguientes condiciones: (1) Este dispositivo no puede provocar interferencia dañina, y (2) este dispositivo debe aceptar cualquier interferencia recibida, incluyendo interferencia que pueden provocar un funcionamiento no deseado.

- Advertencia: Los cambios o modificaciones realizados a esta unidad que no hayan sido expresamente aprobados por la parte responsable del cumplimiento podrían anular la autoridad del usuario para operar el equipamiento.

- NOTA: Este equipamiento se ha probado, determinándose que cumple con los límites para un dispositivo digital Clase B, de acuerdo con la parte 15 de las Reglas de la FCC.

Estos límites están diseñados para proporcionar una protección razonable contra interferencias dañinas en una instalación residencial. Este equipamiento genera, usa y puede irradiar energía de radiofrecuencia, y si no se instala y utiliza en concordancia con las instrucciones, puede causar una interferencia dañina para las radio comunicaciones.

Si embargo, no existe garantía de que no ocurran interferencias en una instalación en particular. Si este equipo produce una interferencia dañina con la recepción de radio o televisión, lo cual puede determinarse apagando y encendiendo el equipo, se exhorta al usuario que trate de corregir la interferencia mediante una o más de las medidas siguientes:

- Reorientar o reubicar la antena receptora.
- Aumentar la separación entre el equipo y el receptor.
- Conectar el equipo a una toma de corriente que pertenezca a un circuito diferente al que está conectado el receptor.
- Consulte con el distribuidor o con un técnico de radio/TV con experiencia para solicitar ayuda.

CAN ICES-3 (B)/NMB-3(B)

Este transmisor no se debe colocar ni operar en conjunto con cualquier otra antena o transmisor. Este equipo debe ser instalado y operado a una distancia mínima de 20 centímetros entre el radiador y su cuerpo.

## Cómo usar su altavoz

### Encendido/Apagado del altavoz

Presione y sostenga el botón **Encendido** por unos 2 segundos para encender el altavoz. Cuando el altavoz está encendido, presione y suelte el botón para reproducir o pausar una canción.

Botón de Encendido/  
Reproducción/Pausa

### Puerto USB de carga

Para cargar el altavoz, conecte el cable USB incluido con el **Puerto de carga** a un costado del altavoz. (Consulte el reverso del manual para las instrucciones detalladas de carga.)

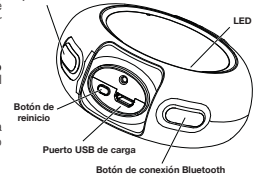

### Botón de reinicio

Pulse rápidamente el botón de reinicio para reiniciar el altavoz. Para restablecer la configuración de Bluetooth, pulse y mantenga pulsado el botón de emparejamiento Bluetooth durante 10 segundos hasta que oiga un tono de confirmación.

### Botón de conexión Bluetooth

Consulte el reverso del manual para las instrucciones detalladas de la conexión Bluetooth.

### llevar a Correa

Para colocar la correa de transporte incluido, bucle a través del gancho en la parte superior de la unidad.

## Cómo usar Bluetooth con el modelo B55

- Verifique que su dispositivo Bluetooth y su altavoz B55 estén debidamente cargados. Encienda su dispositivo Bluetooth y hágalo "aparecer" activando el modo Bluetooth (compruebe la lista en Opciones o Ajustes).
- Cuando el altavoz B55 está encendido, presione y sostenga el botón **Conexión Bluetooth** hasta que suene el tono de confirmación. La luz LED azul parpadeará cuando el altavoz esté intentando conectarse con un dispositivo Bluetooth.
- El mensaje "eKids B55" aparecerá en su dispositivo. Si aparece el mensaje "Not Connected" u otro similar, seleccione "eKids B55" para conectarse.
- Cuando esté conectado, la luz LED azul dejará de parpadear. Ahora podrá transmitir el audio a su altavoz, y controlar su reproducción desde su dispositivo Bluetooth. Recuerde apagar el altavoz y su dispositivo si ya no los va a usar.



Nota: Si no es posible conectar un dispositivo en 5 minutos, el altavoz se apagará automáticamente. Para volver a conectar, repita los pasos 1-4 arriba detallados.